

# m o o o i

Raimond 43/61/89/ Zafu UN

1

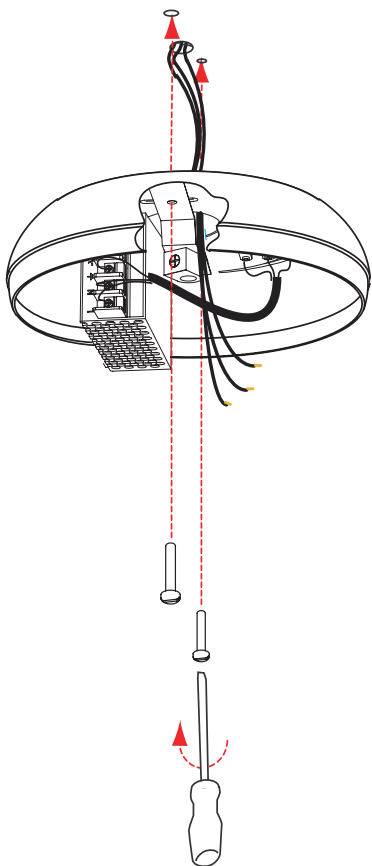

2

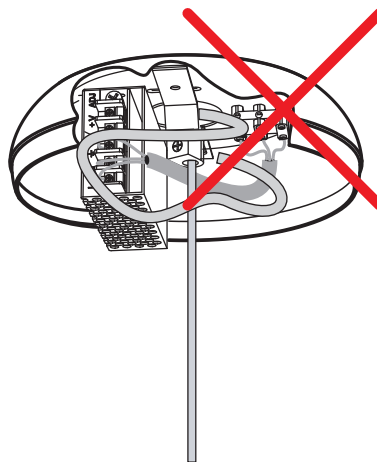

**IMPORTANT NOTE**  
MAKE SURE THE EXCESS CABLE IS  
SHORTER THAN 10CM (4")

3

INPUT: 240V AC

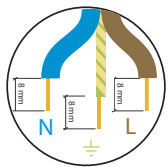

INPUT: 110V AC

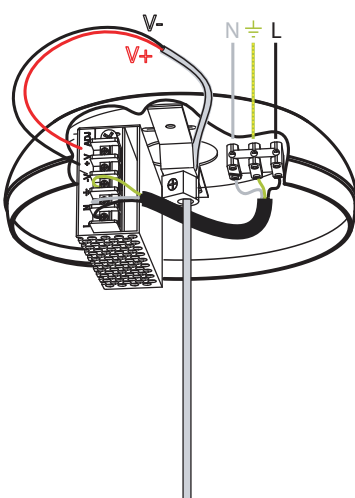
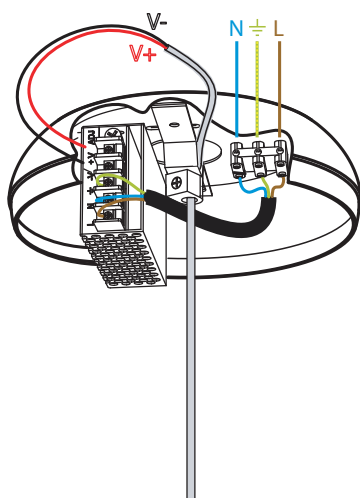
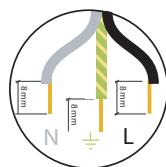

4

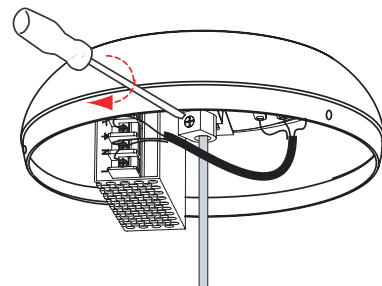

5

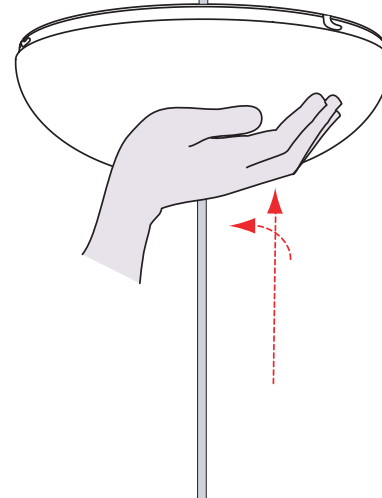

**IMPORTANT NOTE**  
MAINTAIN 30CM (12") OR MORE DISTANCE  
BETWEEN LAMP AND CANOPY

visit [www.mooui.com](http://www.mooui.com) for more information about the collection